

Part number:

060-10113

**HYDROMA**  
HYDRAULICKÉ SYSTÉMY

**HIDROMA**  
SISTEMS  
UKŁADY HYDRAULICZNE

**HYDROMA**  
ГИДРАВЛИЧЕСКИЕ СИСТЕМЫ

## Flow Monitor Flow Indicator

# DKG-2

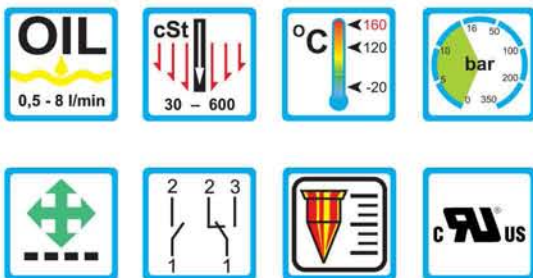

### Range of Applications

#### Operation

- Float measuring principle

#### Application

- Central lubrication
- Circulation lubrication
- Transformers

#### Features

- Universal orientation
- Viscosity compensated
- High switch accuracy
- Infinitely variable switchpoint adjustment through user
- Scales are burned into the sight glass
- Threaded connection, special threads on request

#### Installation hints

- The operating instruction for DKG must be observed!
- Download: [www.meister-flow.com](http://www.meister-flow.com)

### Operating Data

Operating pressure max.	16 bar
Pressure drop	0,02 - 0,2 bar
Viscosity range	30 cSt to 600 cSt
Maximum temperature	120 °C (optional 160 °C)
Accuracy	±10 % of full scale

### Measuring Ranges

Type	Switch range for oil, density 0,9 kg/dm <sup>3</sup> <sup>(1)</sup>		
	[l/min]	[gph]	[gpm]
DKG-2/2	0,5 - 1,7	8,0 - 27,0	
DKG-2/3	0,8 - 2,5	13,0 - 40,0	
DKG-2/4	1,3 - 4,0	21,0 - 63,0	
DKG-2/8	2,5 - 8,0	40,0 - 127,0	

<sup>(1)</sup> The specified data are switch-off points, other switch ranges on request.

# Technical Data

## Mechanical drawing

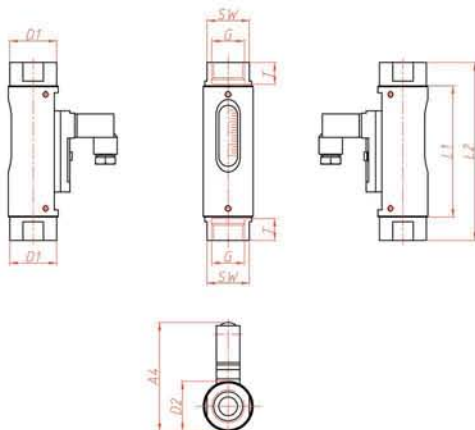

## Connection diagram

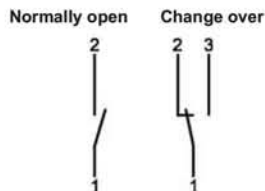

## Electrical Data

<b>Change over</b> <sup>(3)</sup>	250V • 1,5A • 50VA <sup>(2)</sup>
<b>Normally open</b>	230V • 3A • 60VA
<b>Change over M 12x1 (-20 °C - 85 °C)</b>	125V • 1,5A • 50VA <sup>(2)</sup>
<b>Normally open M 12x1 (-20 °C - 85 °C)</b>	125V • 3A • 100VA
<b>Change over SPS</b> <sup>(3)</sup>	250V • 1A • 60VA

### Ingress Protection:

IP65: plug connection DIN 43650 Form C or plug connection M 12x1  
 IP67: 1 m sealed in cable, (with EEx-version 2 m)

### Output signal

The contact opens / changes when the flow decreases below the set point.

### Power supply

Not required (potential free reed contacts)

### Plug types

Other plug types oder cable lengths on request

<sup>(2)</sup> Minimum load 3 VA

<sup>(3)</sup> Only with plug connection

## Summary of types

Type:	Overall dimensions [mm]											Weight approx. [g]	
	SW	L1	L2	D1	G	T	D2	DN	A1	A2	A3		A4
DKG-2/2													
DKG-2/3													
DKG-2/4	27	84	114	30	1/2"	14	32	15	-	-	-	approx. 70	300
DKG-2/8													

## Material

### Brass version

#### Wetted parts:

Sight glass: Duran 50  
 Spring: 1.4571  
 Gaskets: FKM  
 (optional NBR, EPDM) <sup>(4)</sup>  
 Magnets: Hard ferrite

all other wetted parts: Brass nickel-plated

#### Non wetted parts:

Housing: Aluminium anodized

### Stainless steel version

#### Wetted parts:

Sight glass: Duran 50  
 Spring: 1.4571  
 Gaskets: FKM  
 (optional NBR, EPDM) <sup>(4)</sup>  
 Magnets: Hard ferrite

all other wetted parts: 1.4571

#### Non wetted parts:

Housing: Aluminium anodized

<sup>(4)</sup> Other gasket materials on request

DKG-2 0010.07-10 E M