

Part number:

036-10027

HYDROMA

HYDRAULICKÉ SYSTÉMY

**HIDROMA
SISTEMS**

UKŁADY HYDRAULICZNE

HYDROMA

ГИДРАВЛИЧЕСКИЕ СИСТЕМЫ

SQUARED STEEL ELBOWS

| | Type | A | B | C | D | E | F | G | OR | V | Weight |
|--|-------------------|------|----|-----|----|----|----|----|-------------|------------------------|--------|
| | | | | | | | | | O ring | Screw | |
| | RQ 30/12-3/8"BSP | 3/8" | 30 | 6,5 | 12 | 19 | 11 | 41 | ø15,88x2,61 | N°2 M6x20 N°2 M6x35 | 0,29 |
| | RQ 30/12-1/2"BSP | 1/2" | 30 | 6,5 | 12 | 19 | 11 | 41 | ø15,88x2,62 | N°2 M6x20 N°2 M6x35 | 0,29 |
| | RQ 35/15 -3/8"BSP | 3/8" | 35 | 6,5 | 15 | 18 | 11 | 40 | ø18,72x2,62 | N°2 M6x20 N°2 M6x35 | 0,34 |
| | RQ 35/15 -1/2"BSP | 1/2" | 35 | 6,5 | 15 | 18 | 11 | 40 | ø18,72x2,62 | N°2 M6x20 N°2 M6x35 | 0,34 |
| | RQ 40/20-1/2"BSP | 1/2" | 40 | 6,5 | 20 | 24 | 10 | 45 | ø22,22x2,62 | N°2 M6x25 N°2 M6x45 | 0,4 |
| | RQ 40/20-3/4"BSP | 3/4" | 40 | 6,5 | 20 | 24 | 10 | 45 | ø22,22x2,62 | N°2 M6x25 N°2 M6x45 | 0,4 |
| | RQ 55/25-3/4"BSP | 3/4" | 55 | 8,5 | 25 | 35 | 13 | 54 | ø29,75x3,53 | N°2 M8x25 N°2 M8x60 | 0,45 |
| | RQ 55/25-1" BSP | 1" | 55 | 8,5 | 25 | 35 | 13 | 54 | ø29,75x3,53 | N°2 M8x25 N°2 M8x60 | 0,45 |

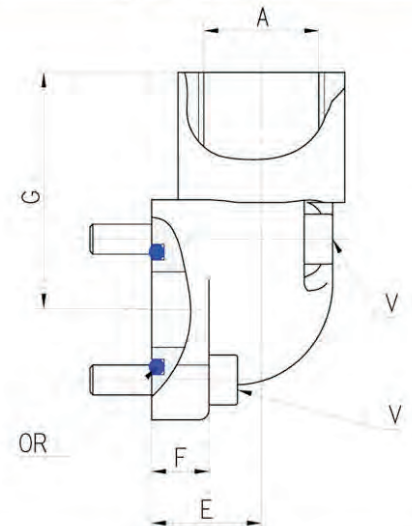
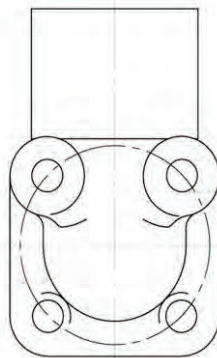

STRAIGHT STEEL UNIONS

| | Type | A | B | C | D | E | F | G | OR | V | Weight |
|--|-----------------------|------|----|-----|----|----|----|----|-------------|-------|--------|
| | | | | | | | | | O ring | Screw | |
| | RD 35/15 (BH)-1/2"BSP | 1/2" | 35 | 6,5 | 14 | 35 | 10 | 40 | ø18,72x2,62 | M6x20 | 0,15 |
| | RD 40/20 (BH)-3/4"BSP | 3/4" | 40 | 6,5 | 17 | 35 | 10 | 40 | ø22,22x2,62 | M6x20 | 0,17 |

