

Part number:

HYDROMA

HYDRAULICKÉ SYSTÉMY

HIDROMA
SISTEMS

UKŁADY HYDRAULICZNE

HYDROMA

ГИДРАВЛИЧЕСКИЕ СИСТЕМЫ

SERIES 80000 PTO GEARBOX PUMP GROUP 3.5 • 36KW

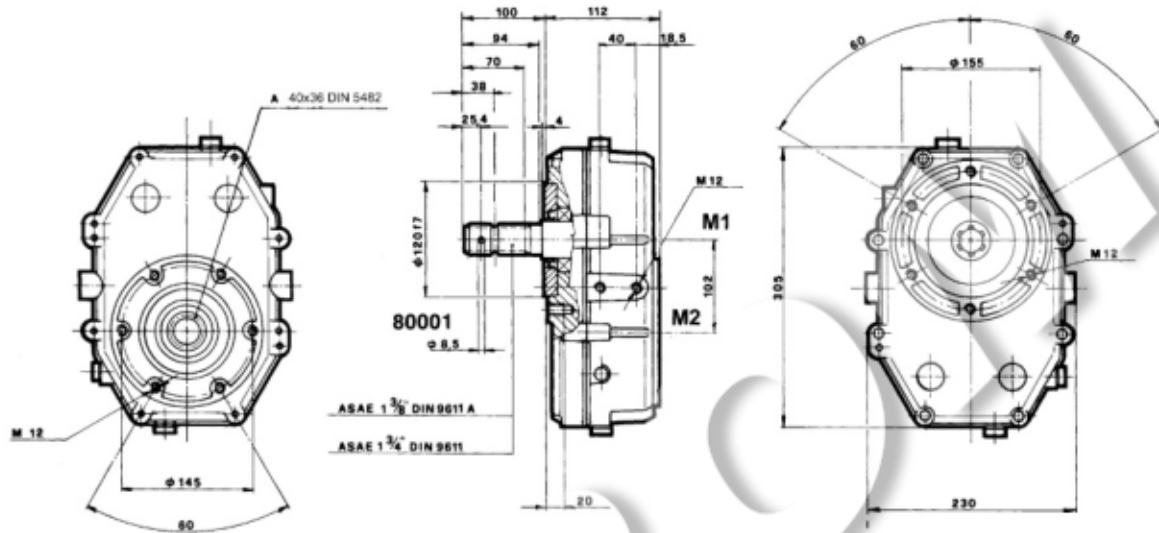

MAX OIL LEVEL 1 LITRE

| M1 MAXIMUM CONTINUOUS TORQUE OF THE PTO GEARBOX (Input side daNm) | M2 MAXIMUM TORQUE OF THE PTO GEARBOX (Output side daNm) | N1 TRACTOR OUTPUT SPEED RPM | N2 FINAL OUTPUT SPEED OF PUMP/GEARBOX ASSEMBLY RPM | RATIO OF SPEED INCREASE | KW MAX TRANSMITTABLE POWER | WEIGHT KG |
|--|---|---|---|-------------------------------|-------------------------------------|--------------|
| 46,6 | 46,6 | 540 | 540 | 1 | 36 | 13,5 |
| 48 | 32 | 540 | 810 | 1,5 | 36 | 13,5 |
| 48,4 | 24,2 | 540 | 1080 | 2 | 36 | 13,5 |
| 46,8 | 18 | 540 | 1408 | 2,5 | 36 | 13,5 |
| 48,9 | 16,3 | 540 | 1620 | 3 | 36 | 13,5 |
| 45,9 | 13,5 | 540 | 1836 | 3,5 | 36 | 13,5 |
| 47,5 | 12 | 540 | 2052 | 3,8 | 36 | 13,5 |
| 47,2 | 11,8 | 540 | 2160 | 4 | 36 | 13,5 |
| 47 | 9,8 | 540 | 2592 | 4,8 | 36 | 13,5 |

| FACTORY PREFIX |
|----------------|
| 35 |

| PTO GEARBOX |
|-------------|
| 80001 |
| 80002 |
| 80003 |
| 80004 |
| 80005 |

| RATIO AVAILABLE |
|-----------------|
| 1 |
| 1,5 |
| 2 |
| 2,5 |
| 3 |
| 3,5 |
| 3,8 |
| 4 |
| 4,8 |

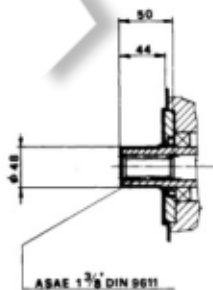

80002

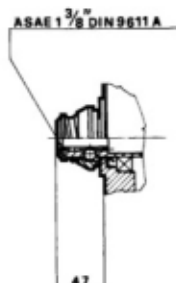

80003

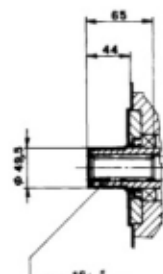

80004

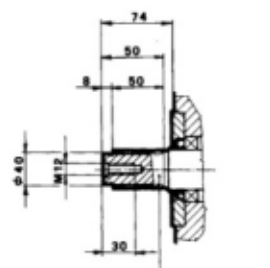

80005

FLANGES TO FIT PTO GEARBOXES 80000-90000-91000

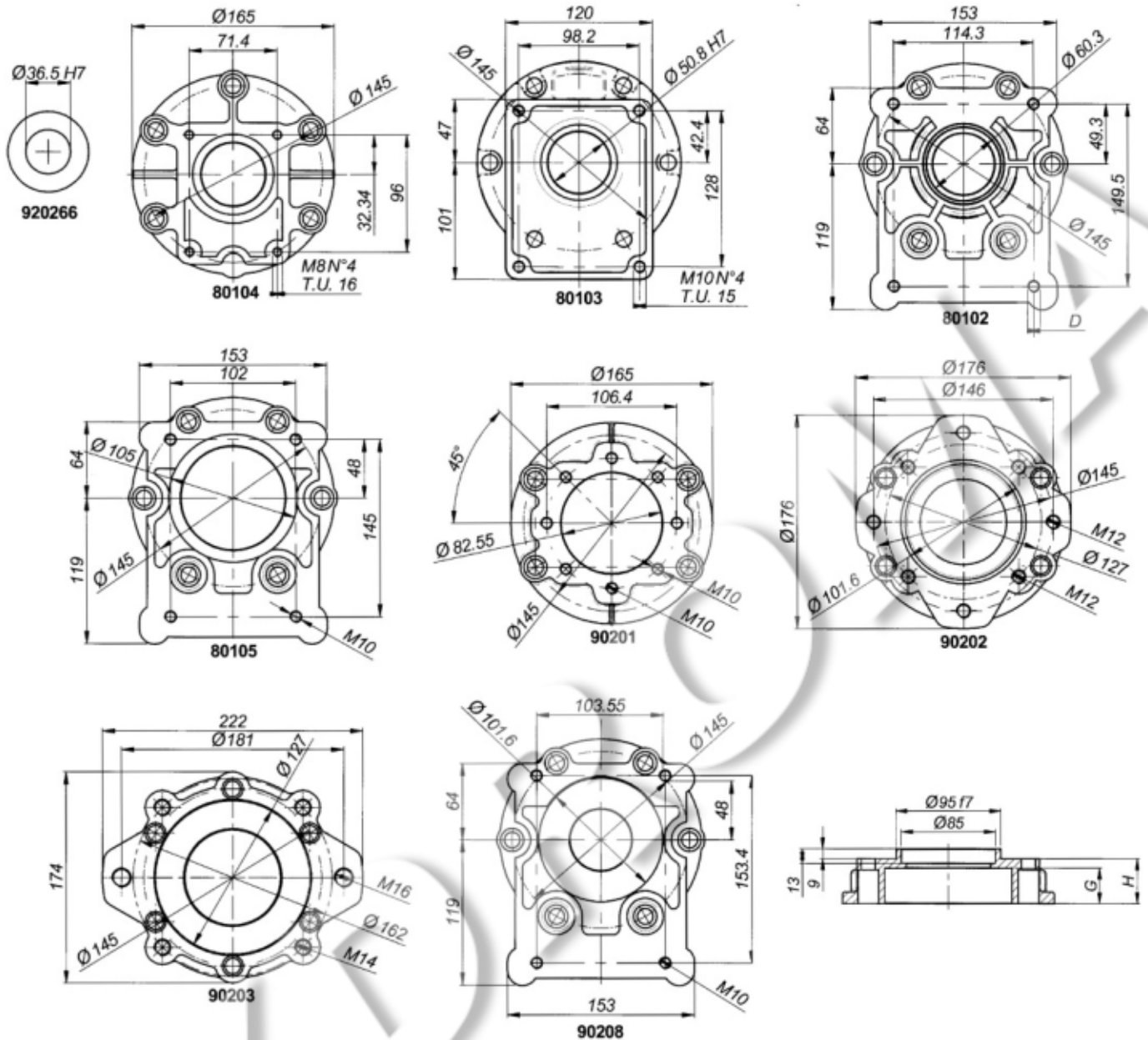

| Code. | FLANGE TYPES | | | | | | | | | | | |
|-------|--------------|-------|--------|-------|------------|-------|-------|-------|------------|---------|---------|-----------------|
| | Gr.2 | Gr.3 | Gr.3.5 | Gr.4 | Gr.3 Bosch | SAE A | SAE B | SAE C | L.G. 20-35 | L.G. 50 | L.G. 75 | ULTRA SPL DOWTY |
| | 80104 | 80103 | 80102 | 80108 | 80105 | 90201 | 90202 | 90203 | 90205 | 90207 | 90209 | 90208 |
| G | 21 | 22 | 24,5 | 36 | 12 | 25 | 12 | 15 | 20,5 | 33 | 57 | 10 |
| H | 21 | 22 | 24,5 | 36 | 24 | 25 | 25 | 28 | 26,5 | 43 | 72 | 24 |