

Part number:

**HYDROMA**

HYDRAULICKÉ SYSTÉMY

**HIDROMA  
SYSTEMS**

UKŁADY HYDRAULICZNE

**HYDROMA**

ГИДРАВЛИЧЕСКИЕ СИСТЕМЫ

**STANDARD MANIFOLDS**

**3 WAY - 4 WAY ALUMINUM SIZE 06**

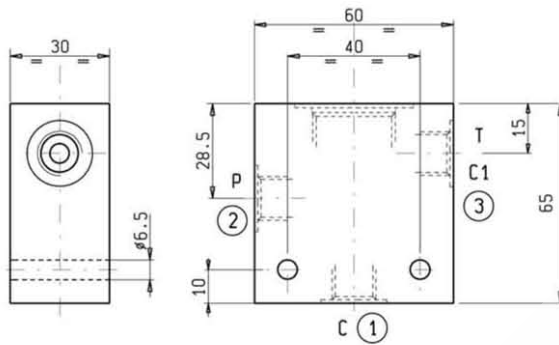

CAVITY **051-E**  
Dimensions on page 7.01.11

ORDERING CODE	PORTS P-C-C1-T	WEIGHT Kg
<b>OC.10.09.042</b>	G 1/4	0.150
<b>OC.10.09.048</b>	G 3/8	0.150

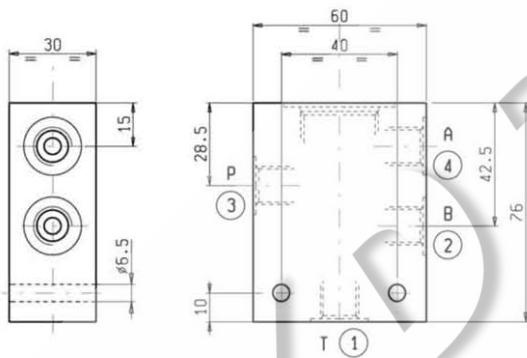

CAVITY **058-E**  
Dimensions on page 7.01.12

ORDERING CODE	PORTS A-B-P-T	WEIGHT Kg
<b>OC.10.09.047</b>	G 1/4	0.150
<b>OC.10.09.046</b>	G 3/8	0.150

**MAX. PRESSURE 250 bar**

**FEATURES**

- Standard manifolds in high-strength aluminum TA-7020 for working pressures up to 250 bar.