

Part number:

**HYDROMA**

HYDRAULICKÉ SYSTÉMY

**HIDROMA  
SYSTEMS**

UKŁADY HYDRAULICZNE

**HYDROMA**

ГИДРАВЛИЧЕСКИЕ СИСТЕМЫ

**EMERGENCY MANIFOLDS**

**2 WAY ALUMINUM**

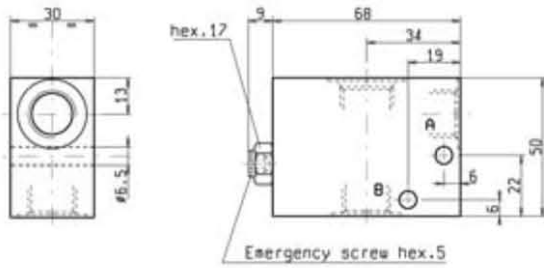

CAVITY **018-E**  
Dimensions on page 7.01.10

ORDERING CODE	PORTS A - B	WEIGHT Kg
OE.15.00.09	G 1/4	0.250
OE.15.00.02	G 3/8	0.250

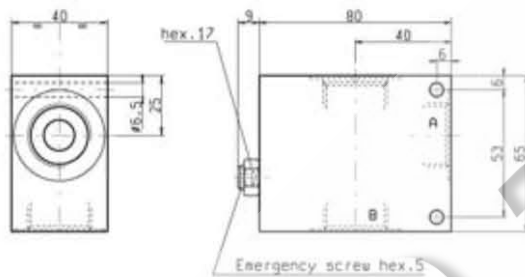

CAVITY **017-E**  
Dimensions on page 7.01.10

ORDERING CODE	PORTS A - B	WEIGHT Kg
OE.15.00.03	G 1/2	0.480
OE.15.00.04	G 3/4	0.480

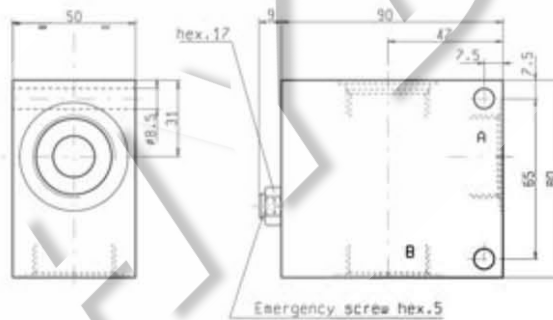

CAVITY **021-E**  
Dimensions on page 7.01.11

ORDERING CODE	PORTS A - B	WEIGHT Kg
OE.15.00.05	G 1	0.750

**MAX. PRESSURE 250 bar**

**FEATURES**

- Standard manifolds in high-strength aluminum TA-7020 for working pressures up to 250 bar.